

Shower Bases Installation Instructions

VALLEY
BATH & KITCHEN

**DO NOT INSTALL THIS
FIXTURE AGAINST A WALL
UNLESS THE APPROPRIATE
FLANGE IS FIRST INSTALLED**



THIS PRODUCT MUST BE INSTALLED BY A QUALIFIED PLUMBER. MAINTAIN THE SURFACE OF THE BASE PROTECTED AT ALL TIMES DURING THE INSTALLATION. THIS PACKAGING BOX CONTAINS FOAM FILM YOU CAN USE TO PROTECT THE BASE DURING THE INSTALLATION ALONG WITH THE BOX LID. PLACE THE FOAM FILM ON THE SURFACE OF THE BASE AND THEN THE BOX LID ON THE FOAM FILM BEFORE INSTALLING, ENSURE TO REMOVE ANY STAPLE FROM THE BOX LID BEFORE USE. ALSO, WATCH FOR SCREWS, STAPLES, DIRT, OR OTHER DEBRIS THAT CAN FALL ON TO THE BASE AND WILL POSSIBLY CAUSE SCRATCHES IF STEPPED ON.

<p>2 People Required</p>		<p>Before you begin</p>				<p>MATERIALS AND TOOLS</p>			
<p>Protective Gloves</p>	<p>Safety Glasses</p>	<p>Hand Screwdriver</p>	<p>Included</p> <p>Tile Flange x2 x1</p>	<p>Tape Measure</p>	<p>Spirit Level</p>	<p>CEMENT</p> <p>Flexible Cement Glue Recommended for installation on concrete floors</p>	<p>Notched trowel</p>	<p>Included</p> <p>Polyurethane Glue</p>	<p>Included</p> <p>Drain</p>

IMPORTANT - STORE BASE ON FLAT PRIOR TO INSTALLATION

READ ENTIRELY THE INSTRUCTIONS. FOLLOW LOCAL PLUMBING AND BUILDING CODES

Prior to installation, the shower base must be checked thoroughly for defects. In the unlikely event that the product has a defect, it must not be installed.

The manufacturer will not be held responsible for the costs of removal or replacement of a shower base or any other costs incurred as a result of the shower base having a defect if said defect was identifiable prior to installation.

INSTALLATION OF THE SHOWER BASE WILL BE TREATED AS ACCEPTANCE OF QUALITY.

Place the shower base on a flat level surface.

Flush with the floor/above floor Installation options

Using a spirit level, ensure that all outer edges of the shower base are flat and level as per figure 1.

If any of the levels cannot be corrected when embedding the shower base, then it may be twisted or distorted. If this is the case, then the shower base must not be installed and should be returned to the retailer for replacement.



Figure 1

INSTALLATION

This product must be installed by a qualified plumber. It is the installer's responsibility to ensure a proper installation, a trouble-free water evacuation and a total watertightness.

Note that this shower base is suitable for installation on both concrete and wooden floors (never on sand only). If fitting to a wooden floor, it is recommended that the ground be made from wood resisting delamination under humid conditions.

Recommended installation:

- 1.- Before installing the shower base:
 - 1.1.- Install the tile flange to the base and seal the corners with polyurethane glue as per Figure 2.
 - 1.2.- Then install the shower drain to the shower base. Drain can not arise from the surface otherwise it will not flow properly.

Do not install this fixture against a wall unless the appropriate flange is first installed.

2.- For the perfect installation of the shower base, it is necessary to create a completely level surface, smooth and dry.

a) For concrete floors:

Pour flexible cement glue for porcelain stoneware tiles on the concrete floor. Spread evenly with a notched trowel as per figure 3a.

b) For wooden floors:

Use polyurethane glue on the wooden floor as per figure 3b.

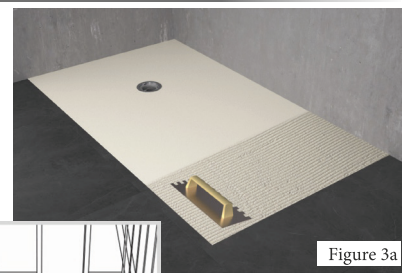

Figure 3a

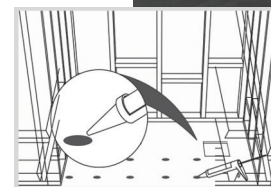

Figure 3b

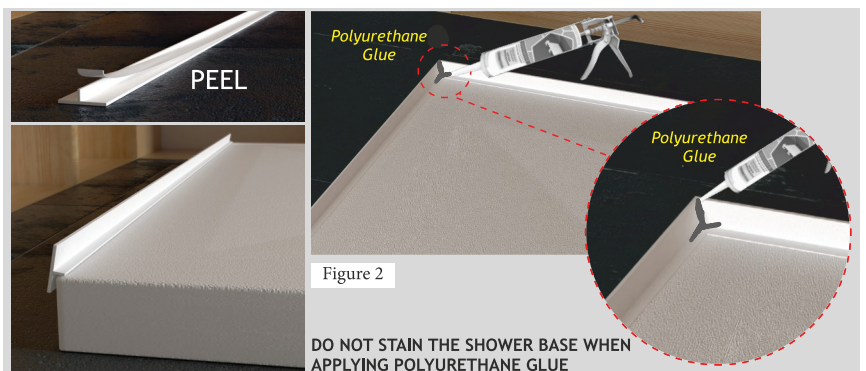

Figure 2

DO NOT STAIN THE SHOWER BASE WHEN APPLYING POLYURETHANE GLUE

! The floor structure must be strong enough to support the weight of the shower base in use. !

3.- Spread polyurethane glue on the underside of the shower base due to be in contact with the floor area as per figure 4.

4.- Settle the shower base into final position and tap level as per figure 5.

5.- Allow the adhesive to set before applying any further weight to the shower base.

6.- Now that the shower base is in final position, place the drain cover on the base.

7.- Before proceeding any further, the shower base must be checked for proper drainage with good water volume poured on to all shower base areas.

If the shower base fails to drain water suitably, then double check that it is level. If the base is level and still fails to drain water, then there may be a blockage in the drainage pipe.

In the unlikely event that the base is faulty, the installation must be halted and the shower base returned to the supplier for replacement.

Tiles/panneling/shower doors/screens or any other fixtures relating to the shower area must not be fitted if the shower base has a fault.

The shower base may not properly drain with integral siphon drains if a second siphon is installed.

8.- It is the installer's responsibility to ensure a total watertightness.

For that purpose, it is recommended to seal the joints, reinforce the flange and the shower drain body with a suitable waterproof caulking without affecting the product features. Oil based caulking, plumber's putty and polyurethane glue are not recommended.

Do not use the shower base within the first 24 hours after installation.

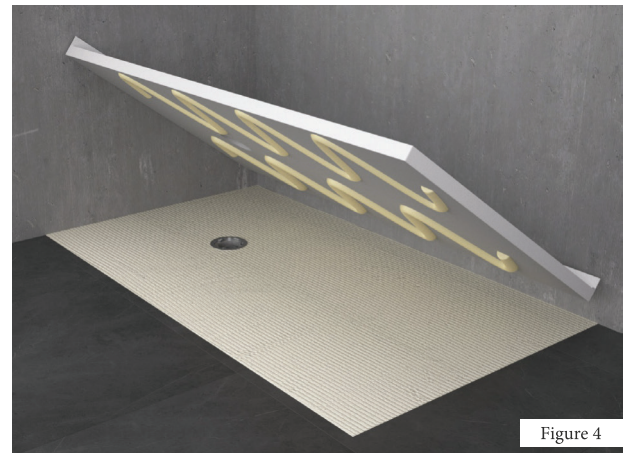

Figure 4



Figure 5



Neutral
Sealant



24 h

**CHECK THAT THE SHOWER BASE
DRAINS PROPERLY.**

IF IN DOUBT, CONTACT YOUR SUPPLIER



**Do NOT drill,
screw or perforate
the shower base**

FINAL RESULT

MAINTENANCE



**Clean regularly with a PH Neutral detergent,
rinse abundantly with water
until there is no residue of detergent and dry.**



**To remove any residue, simply wipe with
a soft clean cloth and PH neutral detergent.
Rinse with abundant water.**



**Avoid the use of scouring sponges
as well as alcohol, solvents,
acid or abrasive products.**